

LEVEL GAUGE & SAMPLE COCK VALVE

Level Gauge Valve with Ferrule End

Application- Used to detect the level of liquid inside a storage tank.

Size Availability- 1"

Material Availability- SS 316L

Connection Availability- Ferrule End



Upper Valve



Lower Valve

Sample Cock Valve with Ferrule End

Method of Operation- Turning the handle allows collection of samples.

Size Availability- 1"

Material Availability- SS 316L

Connection Availability- Ferrule End

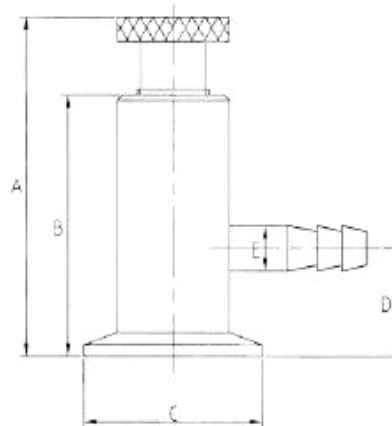

Size	A	B	C	D	E
1"	91.5	70	50.5	29	12
1.5"	91.5	70	50.5	29	12