

NON-RETURN VALVE / CHECK VALVE

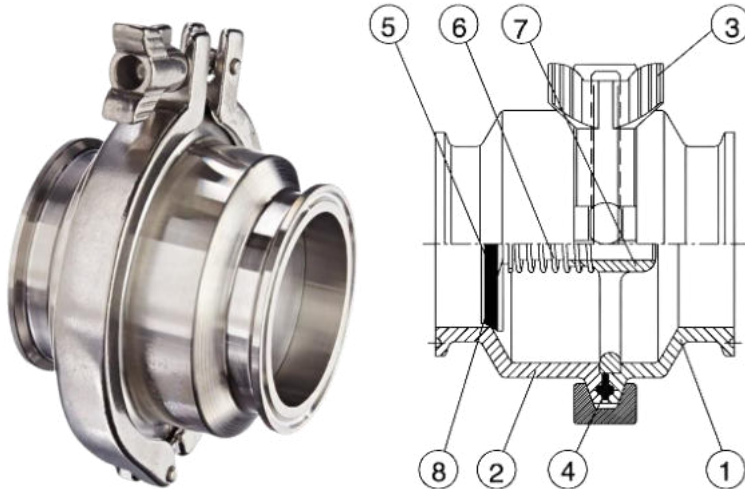

Components List:

No.	Name
1	Short Body
2	Long Body
3	Clamp
4	13 PG
5	Seal Ring
6	ST.ST Spring
7	Flow Support Plate
8	Disc

The sanitary **Check Valve** contains a stainless-steel body which houses a disc supported by a spring. When enough pressure is applied, the disc opens and allows product to flow through.

Method of Operation-

Works automatically when enough flow pressure pushes the disc so that the product flows through.

When pressure is not high enough, the disc remains pushed shut so that the product does not flow through.

Size Availability- 0.5" to 4"

Material Availability- Body in SS 316L, Gaskets in EPDM

Connection Availability- Weld Ends, Ferrule Ends

Pressure to Open Valve- 0.5 psi to 3 psi, depending on size

Opening Pressure (PSI)							
0.5"	0.75"	1"	1.5"	2"	2.5"	3"	4"
0.5	0.5	3	1.6	0.6	1.3	0.8	0.9

NON-RETURN VALVE / CHECK VALVE

Pressure required for opening the valve fitted in a vertical pipe (max pressure- 10 bar):

Spring Check Valve Pressure Drop

(fig. 3)

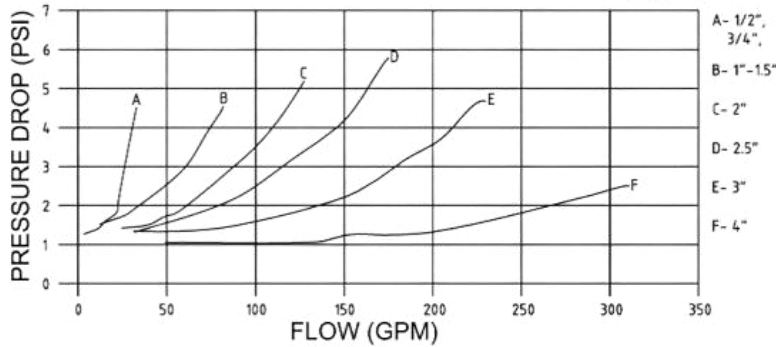

Note:
For the diagram the following applies:
Medium: Water(20°C)

Check Valve with Weld Ends

Size	øA	øB	øC	L1	L2
0.5"	50.5	12.7	9.4	35	22
0.75"	64	19.05	15.75	35	22
1"	64	25.4	22.1	47.5	30.5
1.5"	77.5	38.1	34.8	50	30
2"	91	50.8	47.5	58	30
2.5"	106	63.5	60.2	58	37
3"	119	76.2	72.9	70	36
4"	144.5	101.6	97.6	68	37

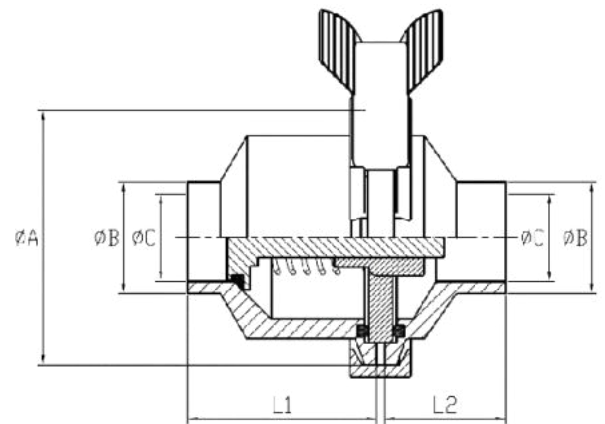

Check Valve with Ferrule Ends

Size	øA	øB	øC	L
0.5"	50.5	25	9.5	88.9
0.75"	64	25	15.8	88.9
1"	64	50.5	22.1	104.8
1.5"	77.5	50.5	34.8	115.9
2"	91	64	47.5	128.6
2.5"	106	77.5	60.2	136.5
3"	119	91	72.9	155.6
4"	144.5	119	97.6	206.4

